



Conveyor Type Dishwasher | C44BP



Warewashing

HOBART

Conveyor Type Dishwasher – C44BP

SIMPLE

EFFICIENT

RELIABLE



	C44BP
Wash Capacity	203 Racks/Hr
6" Plate	5400
8" Plate	3600

Suitable for restaurants, hotels, employee dining with 300–500 seats.
(C44BB upgrade)

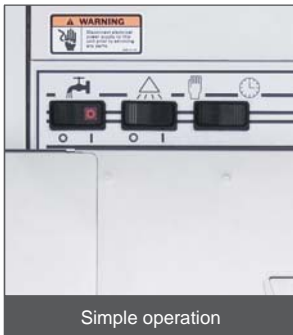

Simple operation

Easy operation – operator friendly

- Compact structure, saving space
- Strainers filling wash chamber, easy to collecting waste and self-flushing
- Taking down wash and rinse arms easily, without any tools
- Wash and rinse temperature display on LED
- Convenient front or top service access to all key components



Waste filter

Outstanding wash results – cleaning friendly

- Powerful booster heater ensures the best cleaning efficient, and satisfies continuous washing when using cooling water
- Wash arms with debossed anti-clogging nozzle
- Reliable heavy-duty wash pump with self-draining for sanitation
- Solid thermostat keep the rinse water temperature above 82°C



Anti-clogging wash nozzle

The reliable safeguard – safety friendly

- A float-activated switch provide automatic tank level control and heater protection
- Automatically close the pump and driving motor when the door opening
- Drain closure when the door closing
- Conveyor jam and overload protection protect conveyor systems and wash chamber
- Top mounted control box with radiator



Touch switch

Saves energy and operation cost – environmental friendly

- Energy saving auto timer activates dishwasher when a rack enters the dishwasher machine , and shuts off the pump when the last rack is washed
- Rack contact with the rinse actuator activities the final rinse
- The high-quality insulation enhance booster' s effect
- One button automatic fill system ensures optimum tank level and automatic tank replenishment

Technical Data

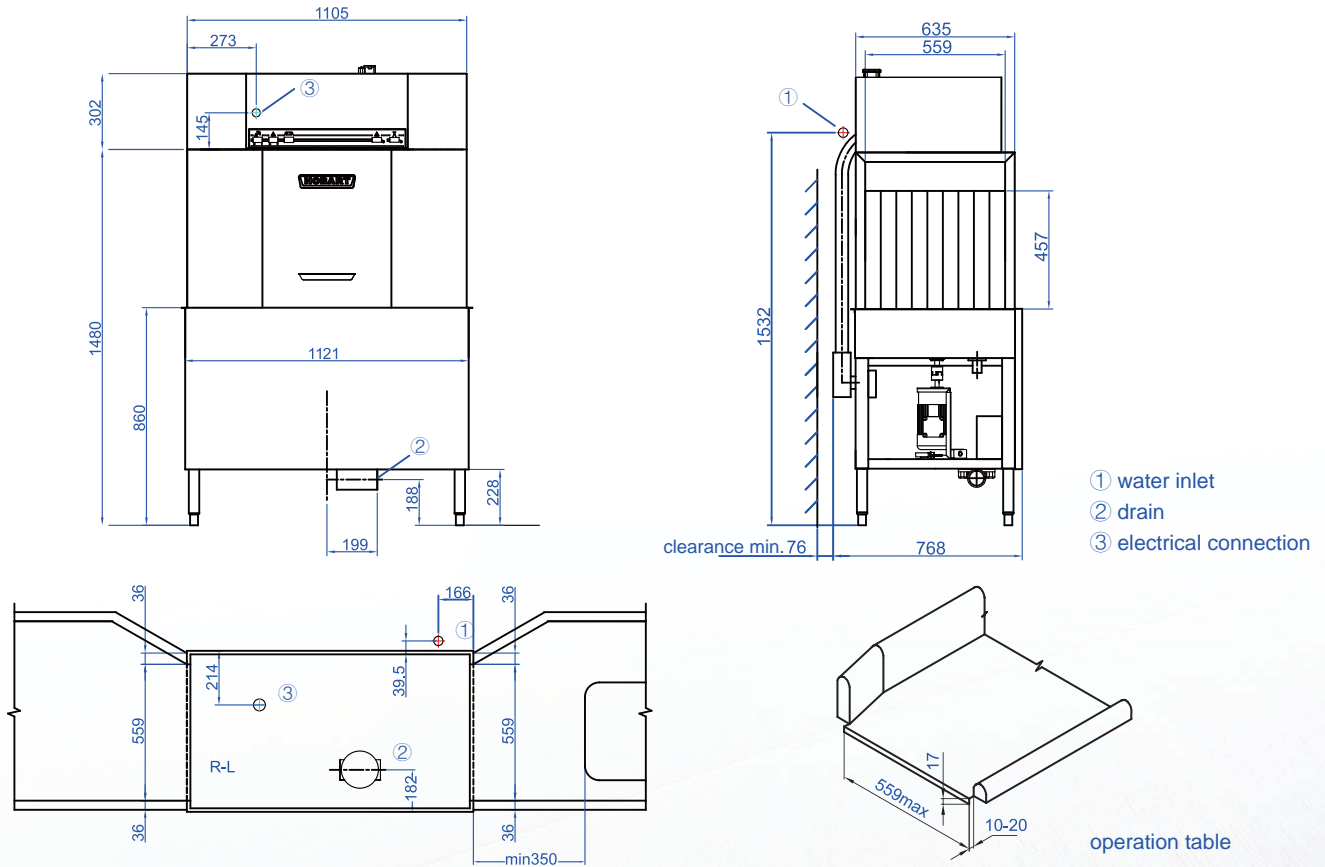

Specification	Unit	C44BP
Wash Capacity	Racks/Hr	203
Tank Volume	L	87
Water Consumption	L	2.13
Water inlet Temperature	°C	10- 80
Wash Pump	kW	1.5
Tank heater	kW	7.5 ; option 15
Booster heater	kW	36
Total Loading	kW	46 ; option 53.5
Electrical Connection	V/Hz/Ph	380/50/3
Washing Height	mm	440
Net Weight	kg	255
Dimension (WxDxH)	mm	1121 x 768 x 1782
Option: Dryer – D36		
Hot-air Circulation	m ³ /h	3600
Fan Power	kW	0.75
Electronic Tube Power	kW	9
Dimension (WxDxH)	mm	920x762x1997

For more information contact Hobart or your local Hobart dealer

ITW FEG (HK) Ltd
HongKong
Tel: 852-2341 9315

Hobart International (Singapore) Pte Ltd
Singapore
Tel: 65-6846 7117

Hobart Food Equipment
Sydney, Australia
Tel: 61-2-9714 0200

Hobart Food Equipment Co., Ltd
Tianjin, China
Tel: 86-22-2397 4914

Hobart (Japan) K.K
Tokyo, Japan
Tel: 813-3744 3511

Hobart Korea LLC
Seoul, Korea
Tel: 822-3443 6901

Hobart (Thailand)
Bangkok, Thailand
Tel: 66-2-675 6279